

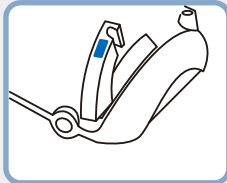

Irrigation tube set up

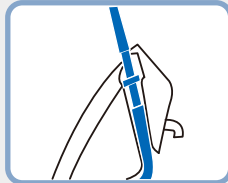

Please press the **PUSH** button to open the pump cover.



Please place the irrigation tube correctly in the pump.

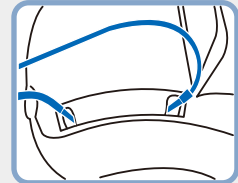
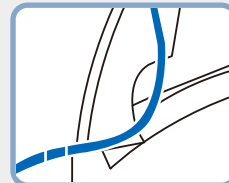

Please press the **PUSH** button to close the pump.

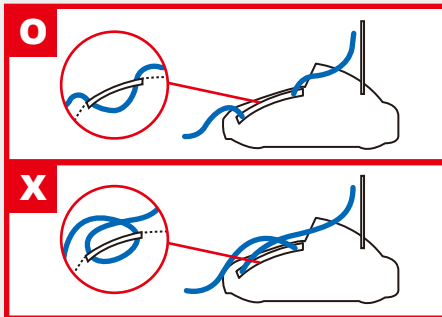

Remain the pump open if you don't use it for a long time. Otherwise, irrigation tube might be defective and it can cause malfunction.



Attention to the direction of the irrigation tube the tube provided is for single use only

How to Clean



Rotate the head in alcohol or water for 5 seconds.



Wipe down the handpiece with a damp disposable cloth.

- **DO** : Within 5 minutes after surgery.
- **DO NOT** : Don't use saline solution for cleaning.

How to Lubricate

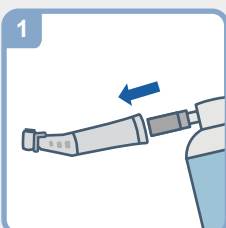

Insert the spray nozzle into the handpiece

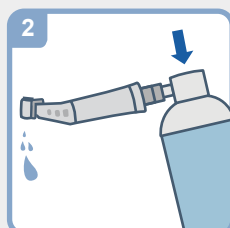

Attached a bur to the angle and spray until the oil coming out of the handpiece is clear



Stand the handpiece upright on a cloth or napkin to let it air dry

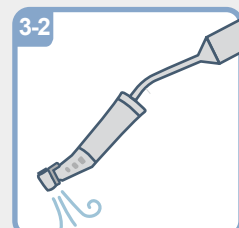

To fast dry: Blow light air pressure into the handpiece.

How to Sterilize



1 Clean the oil on the outer surface of the handpiece.



2 Place the handpiece in a sterilization pouch.

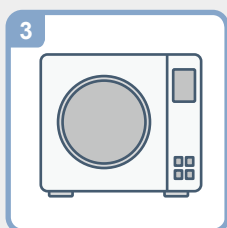

3 Sterilize for 4 minutes at 132 °C and dry for 30 minutes in Autoclave.



Leaving the handpiece with polluted water, saline solution or blood may lead to blood coagulation or rust which can cause breakage. In addition, the Gears or Bearings in the handpiece can get damaged. Completely dry the handpiece before using.

Motor

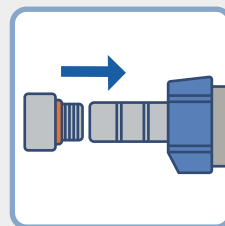

Before placing the handpiece in the autoclave, make sure to assemble the motor cap on the motor.

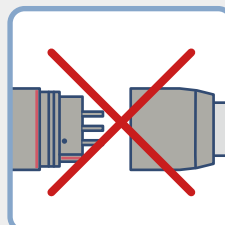

Do not disassemble the motor from the motor cord when sterilizing.

Irrigation nozzle Connection

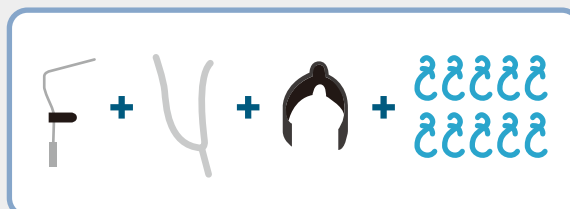
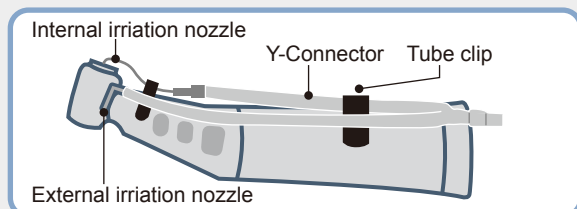
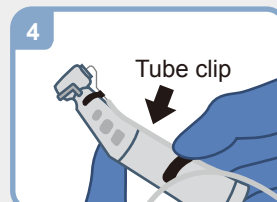
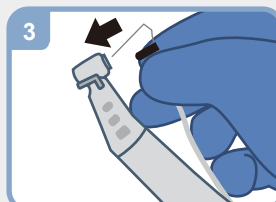
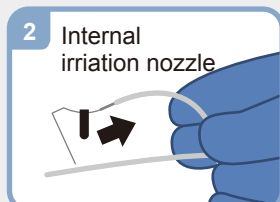
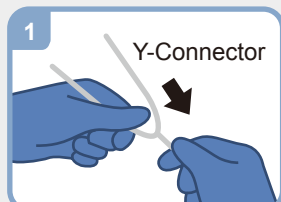

Irrigation tube insertion

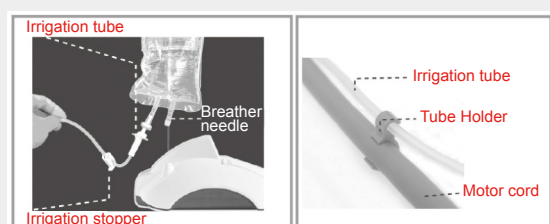

Attention :

If the pump operates while the tube is bent or when water doesn't come out, the tube may be damaged or torn.