



Connection of each part



WARNING

Please make sure that power is off!
(Otherwise, it might cause malfunction.)

Irrigation tube insertion

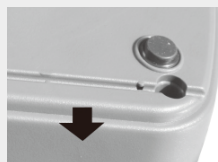
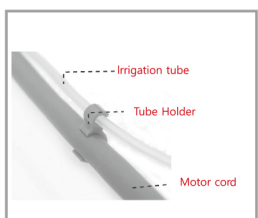
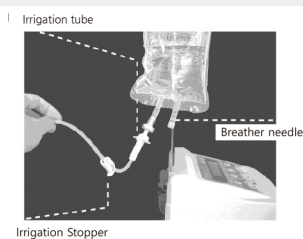

Attention :

If the pump operates while tube is bent or the water doesn't come out, the tube may be damaged or tear. Please operate product after putting the irrigation tube into the groove on the button of control box.

Irrigation tube setup



Right position of irrigation tube

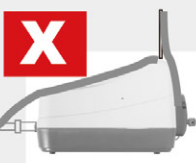

Wrong position of irrigation tube



Right position of irrigation tube



Wrong position of irrigation tube



Do not install the irrigation tube to be on or beside of the membrane. It may cause the damage of product.

When you turn the open-close knob clockwise at the back of control box, pump cover opens and you see the space between the covers. Then insert the irrigation tube into the space, turn the knob counter-clockwise until closing pump covers.



Attention to the direction of the irrigation tube
the tube provided is for single use only

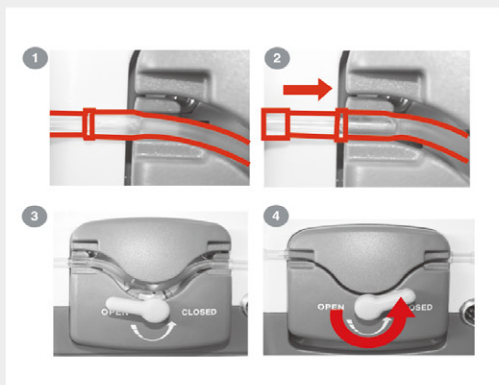

Irrigation nozzle Connection

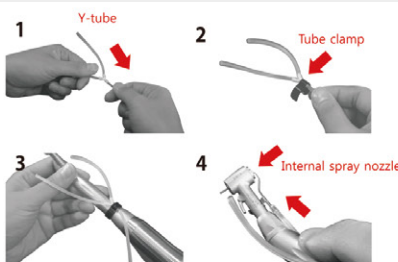
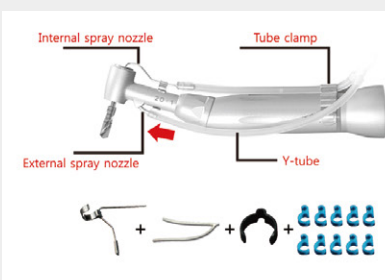

Program setting

X-CUBE has (#1~9) programable memories in conditions below.

set the gear ratio - speed - torque - operation direction - irrigation pump in order and then press the memory button.

Do not operate at program "0". It is for calibration function.

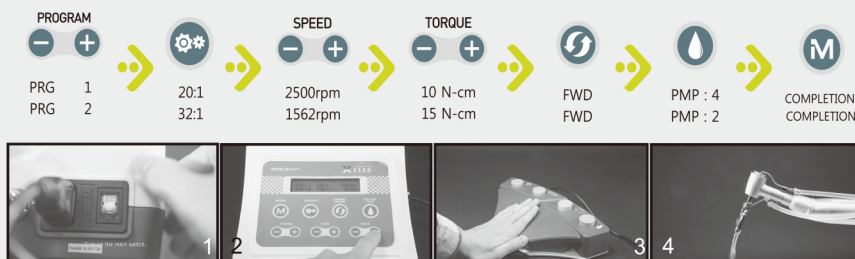

How to maintain a dental handpieces

1 How to Clean

- ◆ Rotate the head in alcohol about 5-6 seconds with high speed right after surgery.
- ◆ After rotate the head, put the three parts after disassemble like in the pic. to remove the remains before the remains get coagulated. After removing the remains, assemble again

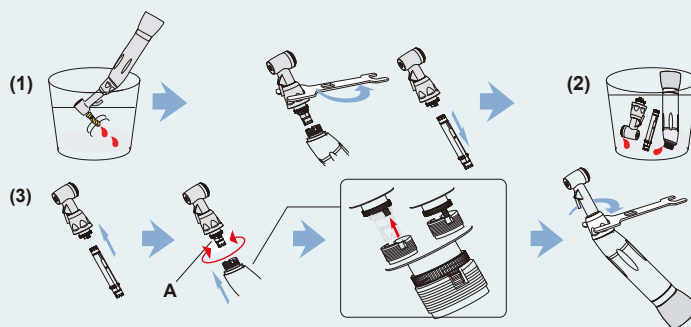

2 How to lubricate

- ◆ Please put the oil (Oiling) to assembled handpiece until clear oil get through out. Refer to the following pic. for the direction of oiling.
- ◆ For disassembled by three parts after alcohol cleaning, Oiling is available.
- ◆ Finish the cleaning with Air dry to Oiled handpieces.

Spray the lubricant when the bur is assembled.

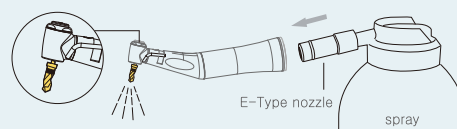

3 How to sterilize

- ◆ After wipe the excess oil outside of the handpiece, put the handpiece with sterilize pack into the autoclave machine and sterilize at 132°C for 4 mins, at 121°C for 20 mins.

For following cases, it may cause the serious damage to the product.

Warning



To keep the handpiece with remains such as physiological saline, blood, its coagulation or rust may cause of breakdown. (Gear and Cartridge may get damaged easily)

Please do the calibration before surgery.
(Please refer to the instruction manual)